

CONTACT	TITLE	SPECIFICATION	SHEET CONTENT	SHEET SIZE	DRAWING NO.
PHONE: 503-360-9551 E-MAIL: sales@hdgbuildingmaterials.com WEB: hdgbuildingmaterials.com	ALUMINUM TRIM HORIZONTAL SIDING DETAIL	TYPICAL DRAWING DETAIL	ISOMETRIC VIEW	A3	ATHSD-01
			BLOW-UP DETAIL		
				DATE 08.08.22	REVISION 0
		CAD BY:	CHECKED BY:		

DIMENSION LEGEND

Millimeter (mm)
Inches (") / Foot (')

RESSJM10 J Mold
Reverse RESSHTC10
Hat Channel
RESSJS10 Siding Starter
J Strip
Existing Wall

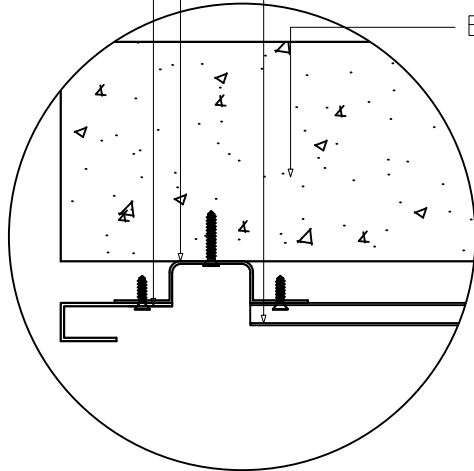

TOP VIEW

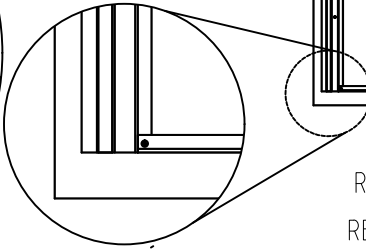

BLOW-UP
ELEVATION

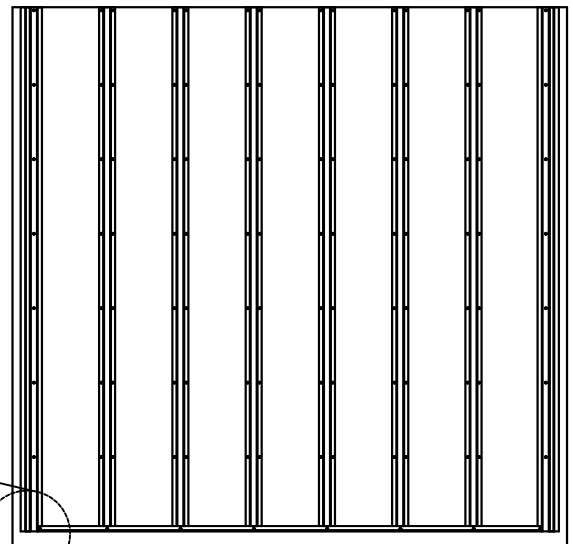

FRONT ELEVATION

RESCPH120612 Siding
RESCPSS25 Stainless
Steel Screw
Reverse RESSHTC10
Hat Channel
RESSJS10 Siding Starter
J Strip
Existing Wall

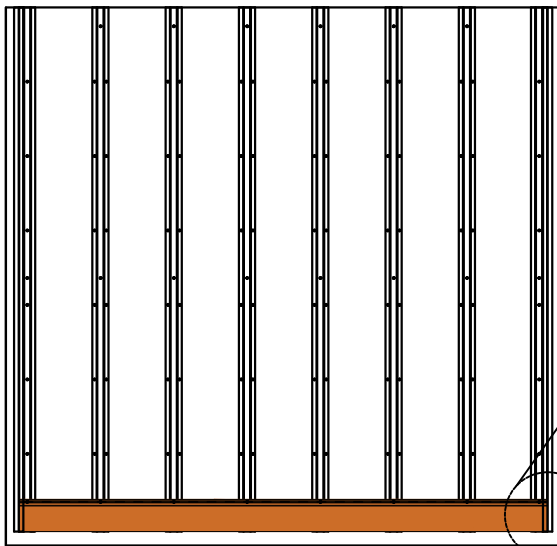

FRONT ELEVATION

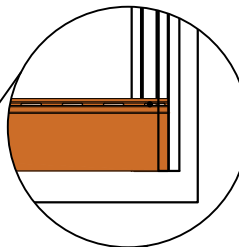

BLOW-UP
ELEVATION

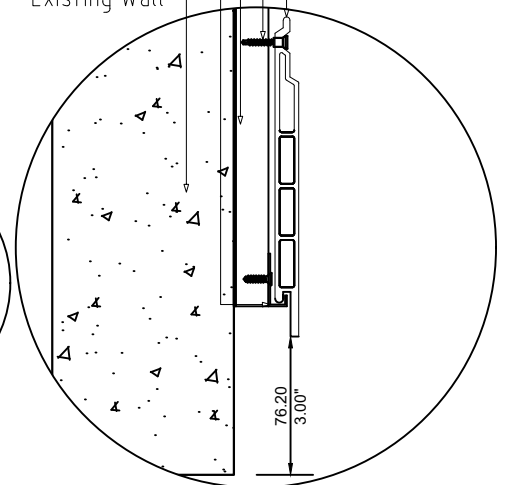

SECTION

Note:

Aluminum starter strip is required to install the Resysta siding board. Attach the starter strip at the bottom of the battens following the fastener and spacing recommendations. The Resysta siding boards will hang 1/2" below the bottom of the starter strip therefore the starter strip should be attached accordingly as per the pre plan layout.

SUB-DETAIL ATVSD 1.1

SCALE
0 100 200 1000



CONTACT	TITLE	SHEET CONTENT	
PHONE: 503-360-9551 E-MAIL: sales@hdgbuildingmaterials.com WEB: hdgbuildingmaterials.com	ALUMINUM TRIM HORIZONTAL SIDING SUB-DETAIL	ELEVATION	
		BLOW-UP DETAIL	
	SPECIFICATION	SECTION	
		TOP VIEW	
		DRAWING NO.	DATE
	ATHSD-02	08.08.22	
	TYPICAL DRAWING DETAIL	CAD BY:	CHECKED BY:

DIMENSION LEGEND

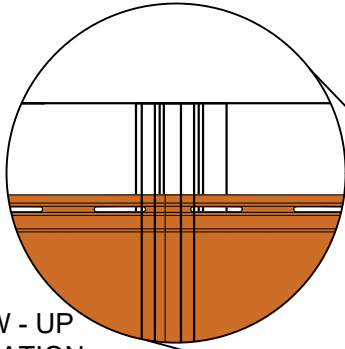
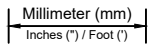

BLOW - UP
ELEVATION

RESSHM10 Siding H Mold

RESSHTC10 Hat Channel

Existing Wall

RESCPH120612 Siding

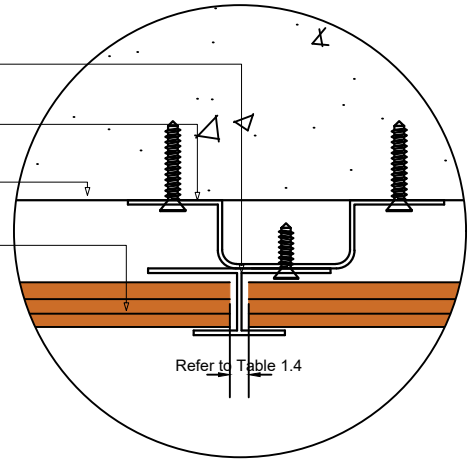

Refer to Table 1.4

TOP VIEW

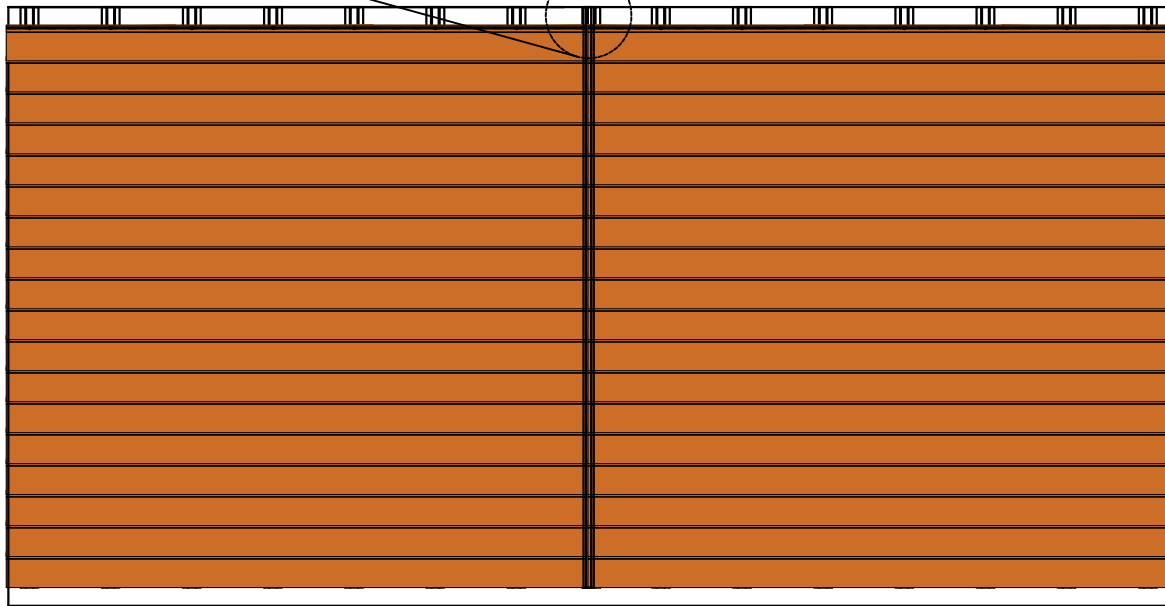

FRONT ELEVATION

SUB-DETAIL ATVSD 1.2



RESSHM10 Siding H Mold

RESSHTC10 Hat Channel

Existing Wall

RESCPH120612 Siding

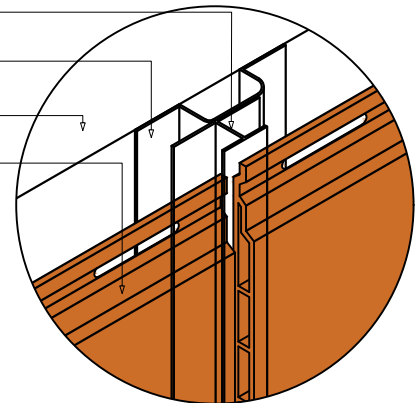

ISOMETRIC VIEW

Table 1.4 "Resysta Expansion"

Resysta Siding Board Gap Guide					
	Aluminum Trim Gap of Siding Boards				H-Channel Gap
Temperature at Installation	Below 30 0F	60 0F	90 0F	120 0F	
Amount for Siding Profile - Length of 12 ft.	7/16"	5/16"	3/16"	0"	1/4"

Note :

An H-Channel should be installed at each board abutment joint to cover the ends of the Resysta siding board. This is a option for installations using 3 or more boards abutted end-to-end



CONTACT	TITLE	SHEET CONTENT	
PHONE: 503-360-9551	ALUMINUM TRIM HORIZONTAL SIDING SUB-DETAIL	ELEVATION	
E-MAIL: sales@hdgbuildingmaterials.com		BLOW-UP DETAIL	
WEB: hdgbuildingmaterials.com	SPECIFICATION	TOP VIEW	
	TYPICAL DRAWING DETAIL	ISOMETRIC VIEW	
		DRAWING NO.	DATE
		ATHSD-03	08.08.22
		CAD BY:	CHECKED BY:

DIMENSION LEGEND

Millimeter (mm)
Inches (") / Foot (')

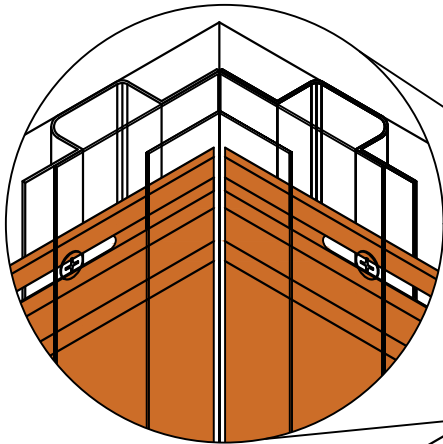

BLOW-UP
ISOMETRIC

RESCPH120612 Siding
RESSIC10 Inside Corner Mold
Gap_Refer to Table 1.4
Reverse RESSHTC10
Hat Channel
RESCPSS25 Stainless
Steel Screw
Existing Wall

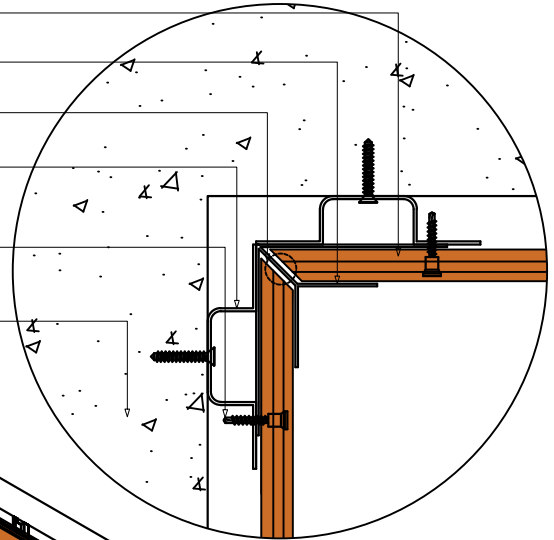

TOP VIEW

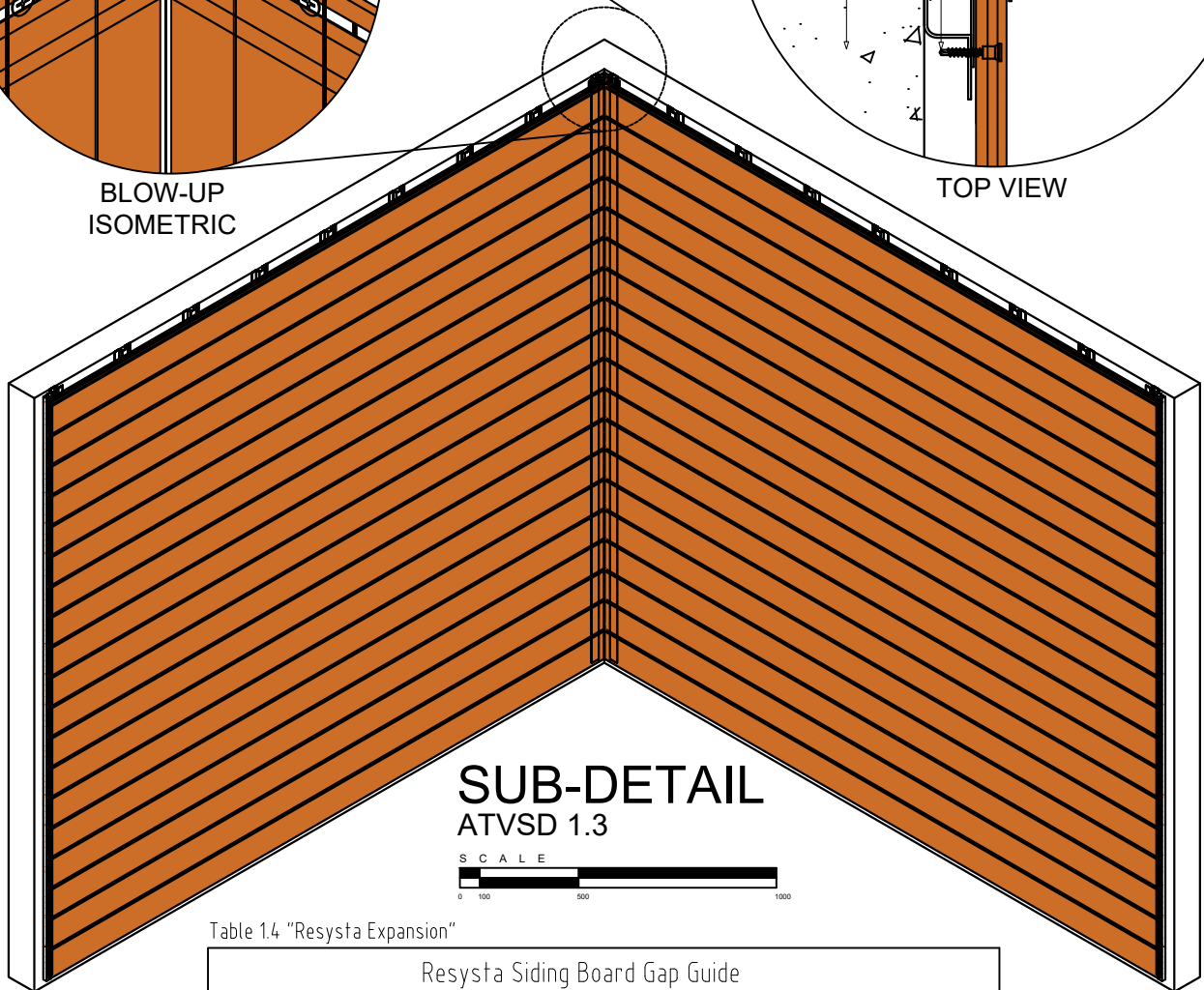

SUB-DETAIL ATVSD 1.3

SCALE
0 100 500 1000

Table 1.4 "Resysta Expansion"

Resysta Siding Board Gap Guide					
Temperature at Installation	Aluminum Trim Gap of Siding Boards				H-Channel Gap
	Below 30 OF	60 OF	90 OF	120 OF	
Amount for Siding Profile - Length of 12 ft.	7/16"	5/16"	3/16"	0"	1/4"

ISOMETRIC
VIEW

Note :

Inside corner trim should be pre-applied prior to installing siding boards. The starter strip for the first board should be installed butted against the corner trim, not overlapping the corner trim attachment. Follow the gap guide when installing the siding board to allow for expansion and contraction within the inside corner trim.



CONTACT	TITLE	SHEET CONTENT	
PHONE: 503-360-9551	ALUMINUM TRIM HORIZONTAL SIDING SUB-DETAIL	ISOMETRIC VIEW	
E-MAIL: sales@hdbgbuildingmaterials.com		BLOW-UP ISOMETRIC	
WEB: hdbgbuildingmaterials.com	SPECIFICATION	TOP VIEW	
	TYPICAL DRAWING DETAIL	DRAWING NO.	DATE
		ATHSD-04	08.08.22
		CAD BY:	CHECKED BY:

DIMENSION LEGEND

Millimeter (mm)
Inches (") / Foot (')

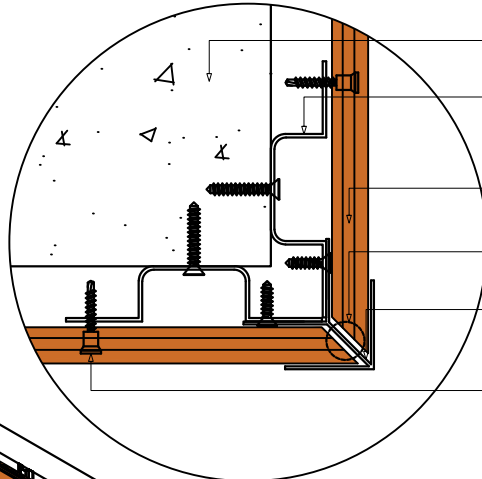

Existing Wall
Reverse RESSHTC10
Hat Channel
RESCPH120612 Siding
Gap_Refer to Table 1.4
RESSOC10 Outside Corner Mold
RESCPSS25 Stainless
Steel Screw

TOP VIEW

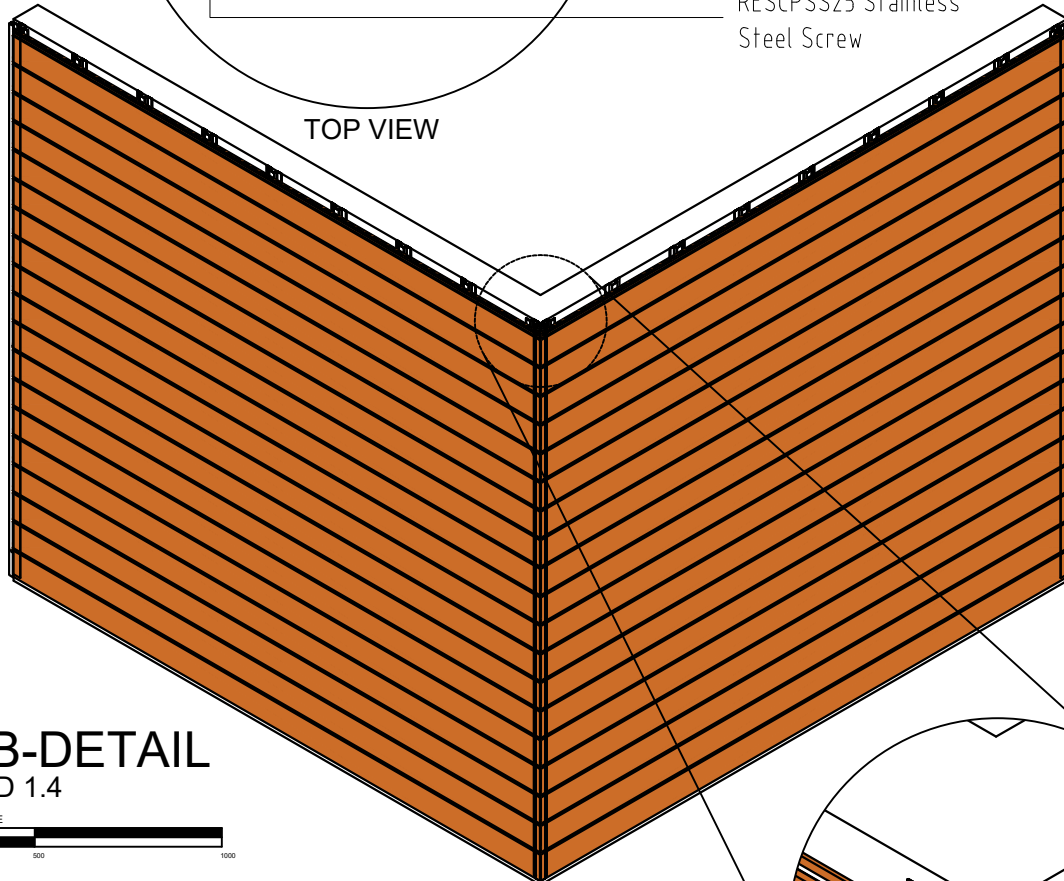

ISOMETRIC VIEW

SUB-DETAIL ATVSD 1.4



Table 1.4 "Resysta Expansion"

Resysta Siding Board Gap Guide					
	Aluminum Trim Gap of Siding Boards				H-Channel Gap
Temperature at Installation	Below 30 OF	60 OF	90 OF	120 OF	
Amount for Siding Profile - Length of 12 ft.	7/16"	5/16"	3/16"	0"	1/4"

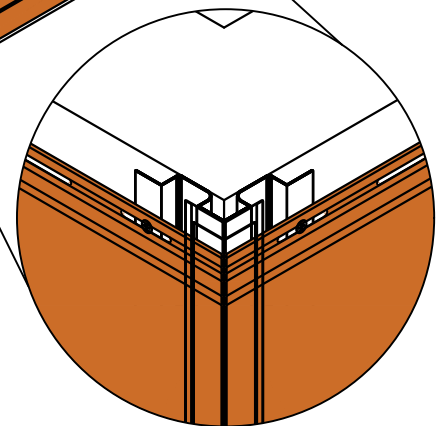

BLOW-UP ISOMETRIC

Note :

Outside corner trim should be pre applied prior to installing siding boards. The starter strip for the first board should be installed butted against the corner trim, not overlapping the corner trim attachment. The siding board end that is inserted into the outside corner should be miter cut at a 45 degree angle to match up with the outside corner internal web.



CONTACT	TITLE	SHEET CONTENT	
PHONE: 503-360-9551 E-MAIL: sales@hdgbuildingmaterials.com WEB: hdgbuildingmaterials.com	ALUMINUM TRIM HORIZONTAL SIDING SUB-DETAIL	ISOMETRIC VIEW	
		BLOW-UP ISOMETRIC	
		TOP VIEW	
	SPECIFICATION	DRAWING NO.	DATE
	TYPICAL DRAWING DETAIL	ATHSD-05	08.08.22
		CAD BY:	CHECKED BY:

DIMENSION LEGEND

Millimeter (mm)
Inches (") / Foot (')

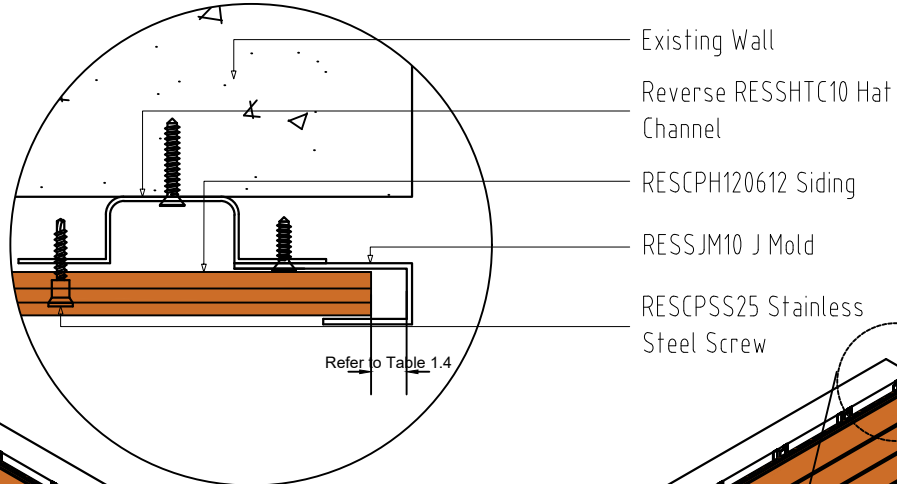

TOP VIEW

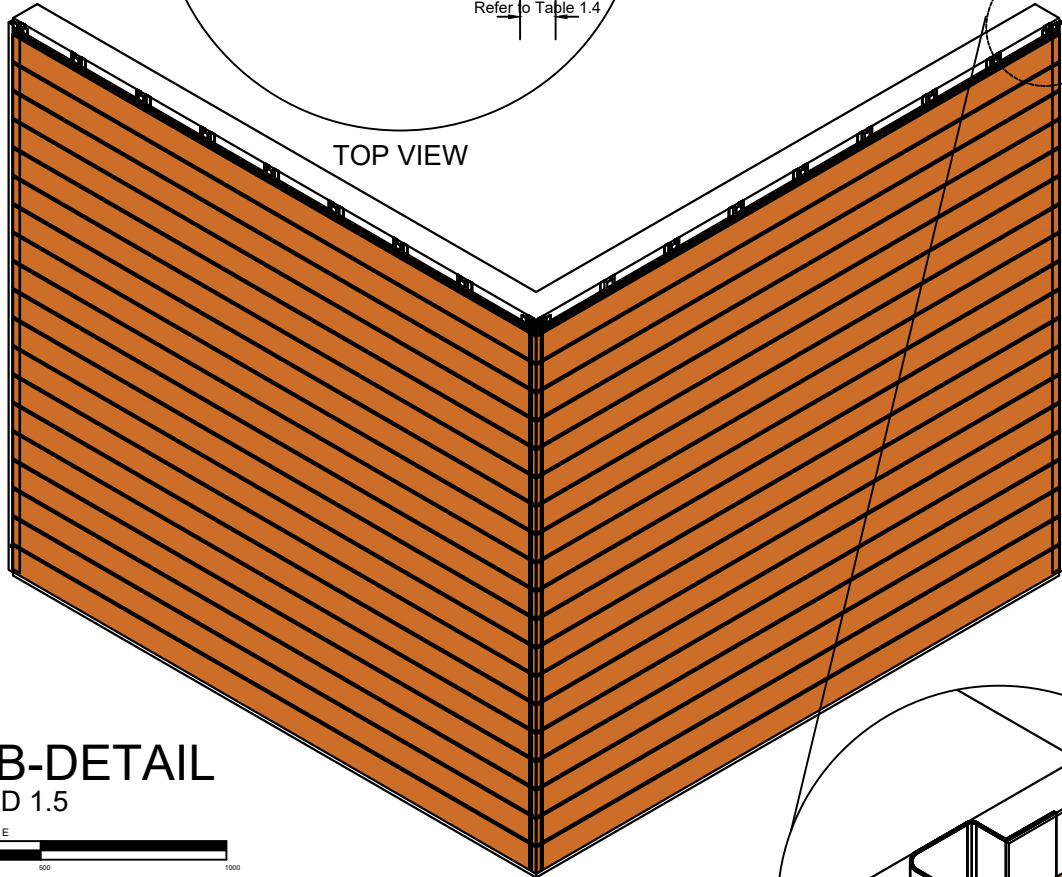

ISOMETRIC VIEW

SUB-DETAIL ATVSD 1.5



Table 1.4 "Resysta Expansion"

Resysta Siding Board Gap Guide					
	Aluminum Trim Gap of Siding Boards				H-Channel Gap
Temperature at Installation	Below 30 0F	60 0F	90 0F	120 0F	
Amount for Siding Profile - Length of 12 ft.	7/16"	5/16"	3/16"	0"	1/4"

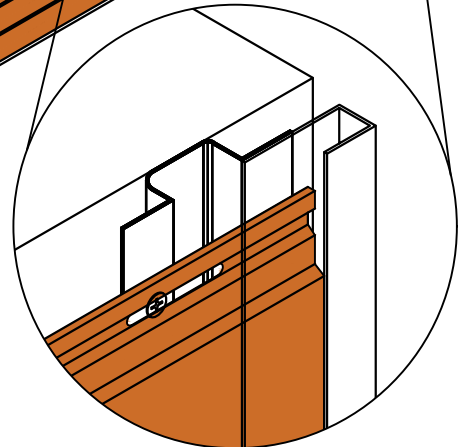

BLOW-UP ISOMETRIC

Note :

When a siding board in either a horizontal or vertical application terminates into a wall, eave, window, door etc. a J-channel should be used to cover the exposed end of the siding board. The J-channel should also be used along the bottom of a vertical installation. J-channel trim should be pre-applied prior to installing siding boards.



CONTACT	TITLE	SHEET CONTENT	
PHONE: 503-360-9551	ALUMINUM TRIM HORIZONTAL SIDING SUB-DETAIL	ISOMETRIC VIEW	
E-MAIL: sales@hdgbuildingmaterials.com		BLOW-UP ISOMETRIC	
WEB: hdgbuildingmaterials.com	SPECIFICATION	TOP VIEW	
	TYPICAL DRAWING DETAIL	DRAWING NO.	DATE
		ATHSD-06	08.08.22
		CAD BY:	CHECKED BY: