

1
ATVSD-1

ISOMETRIC VIEW
ALUMINUM TRIM VERTICAL SIDING DETAIL (ATVSD)
N.T.S



CONTACT	TITLE	SPECIFICATION	SHEET CONTENT	SHEET SIZE	DRAWING NO.
PHONE: 503-360-9551 E-MAIL: sales@hdgbuildingmaterials.com WEB: hdgbuildingmaterials.com	ALUMINUM TRIM VERTICAL SIDING DETAIL	TYPICAL DRAWING DETAIL	ISOMETRIC VIEW BLOW-UP DETAIL	A3	ATVSD-01
		CAD BY:	CHECKED BY:	DATE	REVISION
				03.01.23	0

DIMENSION LEGEND	
Millimeter (mm)	Inches (") / Foot (')

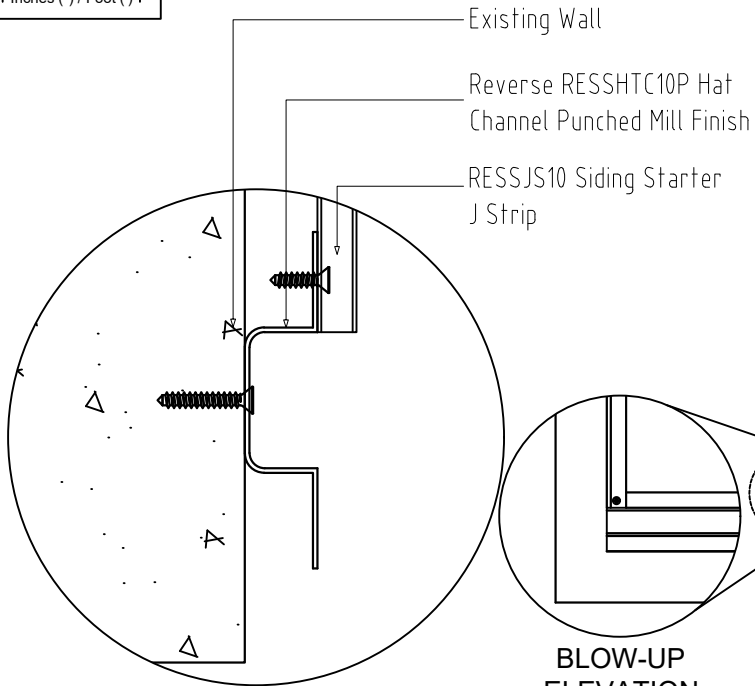

SECTION

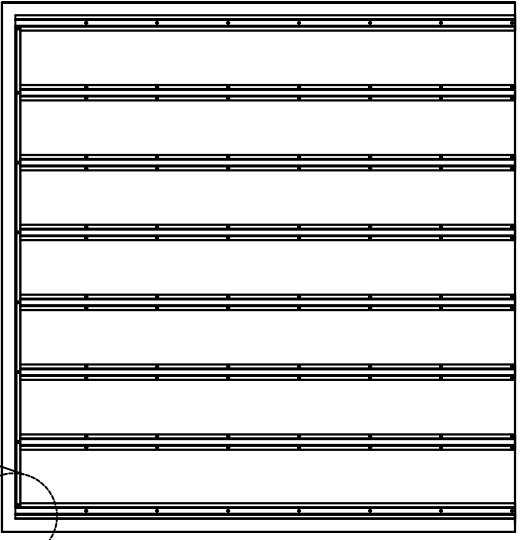

FRONT ELEVATION

- RESSJS10 Siding Starter J Strip
- RESCPSS25 Stainless Steel Screw
- Reverse RESSHTC10P Hat Channel Punched Mill Finish
- RESCPH120612 Siding
- Existing Wall

BLOW-UP ELEVATION

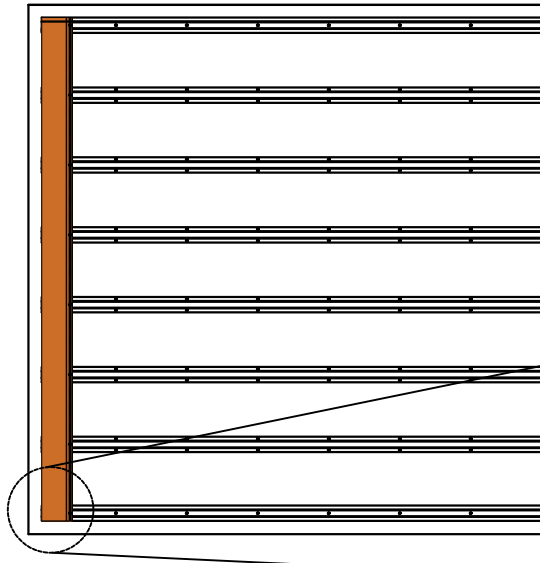

FRONT ELEVATION

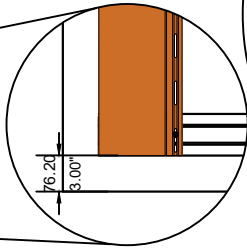

BLOW-UP ELEVATION

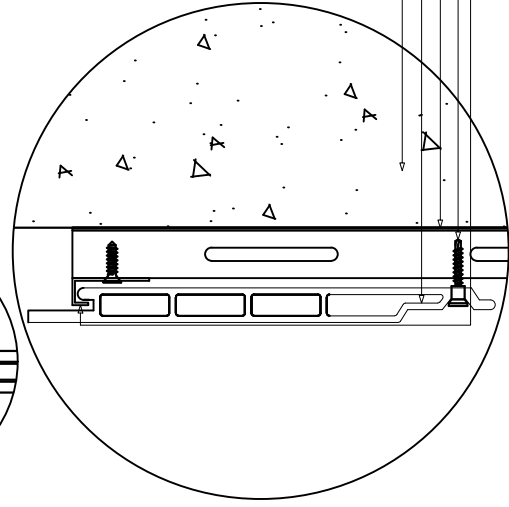

TOP VIEW

Note:

SUB-DETAIL
ATVSD 1.1
N.T.S

Aluminum starter strip is required to install the Resysta siding board. Attach the starter strip at the bottom of the battens following the fastener and spacing recommendations. The Resysta siding boards will hang 1/2" below the bottom of the starter strip therefore the starter strip should be attached accordingly as per the pre plan layout.



CONTACT PHONE: 503-360-9551 E-MAIL: sales@hdgbuildingmaterials.com WEB: hdgbuildingmaterials.com	TITLE ALUMINUM TRIM VERTICAL SIDING SUB-DETAIL	SHEET CONTENT ELEVATION BLOW-UP DETAIL SECTION TOP VIEW	
	SPECIFICATION TYPICAL DRAWING DETAIL	DRAWING NO. ATVSD-02	DATE 03.01.23
		CAD BY:	CHECKED BY:

DIMENSION LEGEND

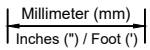

- 10mm / 0.40" ϕ Veneer Cap
- Reverse RESHTC10P Hat Channel Punched Mill Finish
- RESCPH120612 Siding
- RESSIC10 Inside Corner Mold
- Gap_ Refer to Table 1.4
- RESCPSS25 Stainless Steel Screw
- Existing Wall

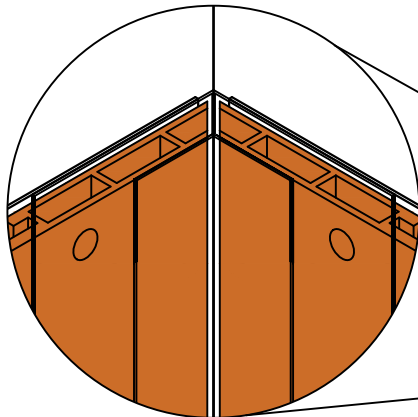

**BLOW-UP
ISOMETRIC**

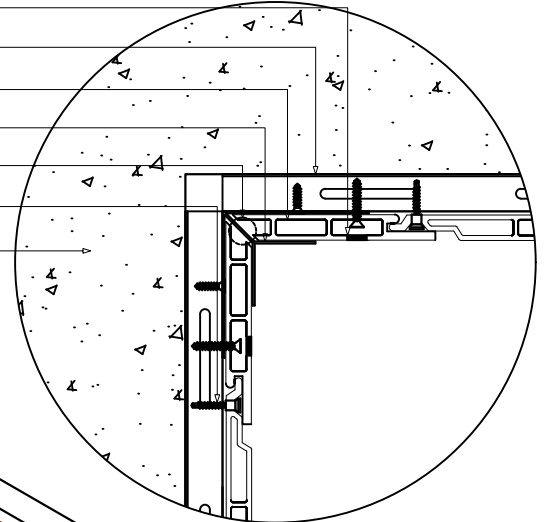

TOP VIEW

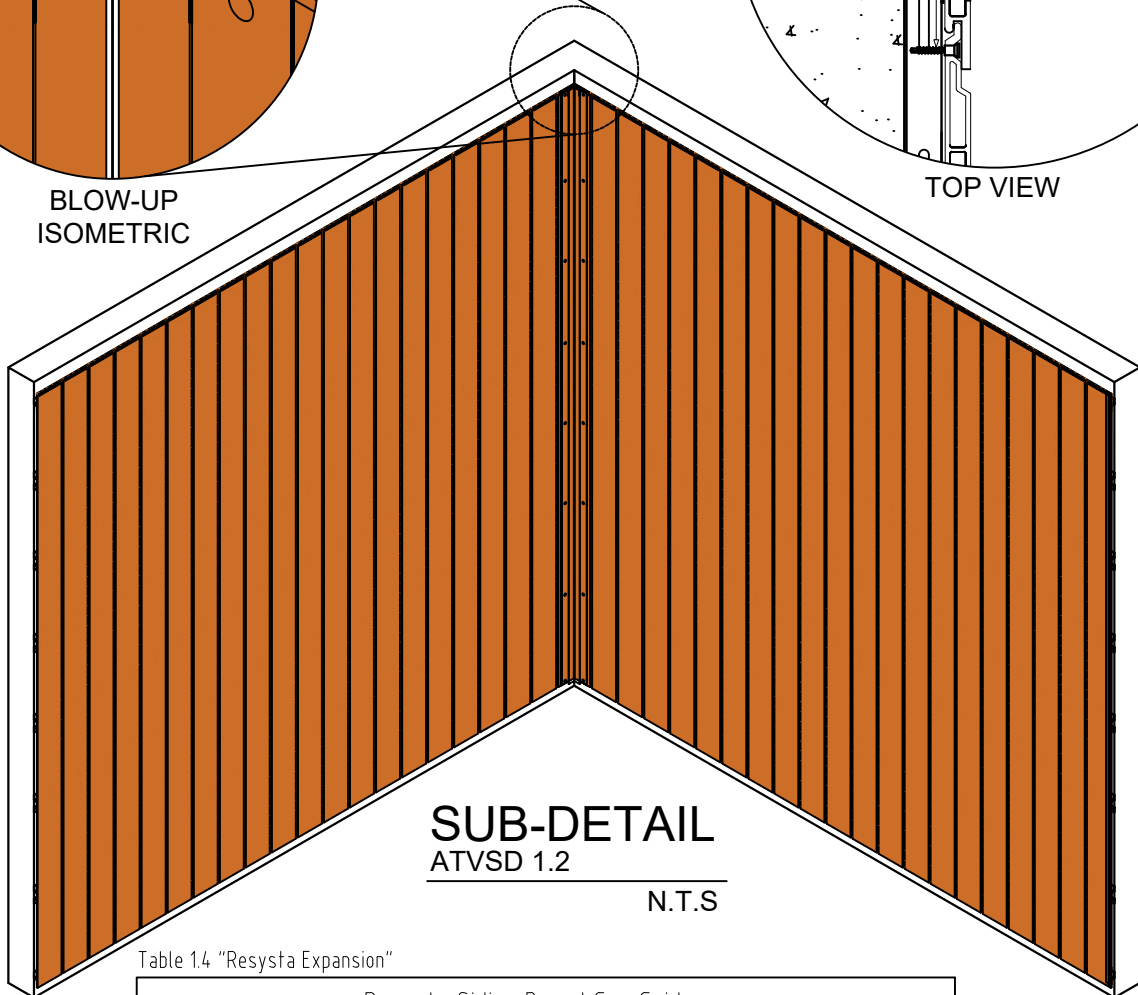

SUB-DETAIL

ATVSD 1.2

N.T.S

**ISOMETRIC
VIEW**

Table 1.4 "Resysta Expansion"

Resysta Siding Board Gap Guide					
Temperature at Installation	Aluminum Trim Gap of Siding Boards				H-Channel Gap
	Below 30°F	60°F	90°F	120°F	
Amount for Wall cladding Profile - Length of 12 ft.	7/16"	5/16"	3/16"	0"	1/4"

Note :

Inside corner trim should be pre-applied prior to installing siding boards. The starter strip for the first board should be installed butted against the corner trim, not overlapping the corner trim attachment. Follow the gap guide when installing the siding board to allow for expansion and contraction within the inside corner trim.



CONTACT	TITLE	SHEET CONTENT	
PHONE: 503-360-9551 E-MAIL: sales@hdgbuildingmaterials.com WEB: hdgbuildingmaterials.com	ALUMINUM TRIM VERTICAL SIDING SUB-DETAIL	ISOMETRIC VIEW	DATE 03.01.23
	SPECIFICATION TYPICAL DRAWING DETAIL	BLOW-UP ISOMETRIC	
		TOP VIEW	

DIMENSION LEGEND

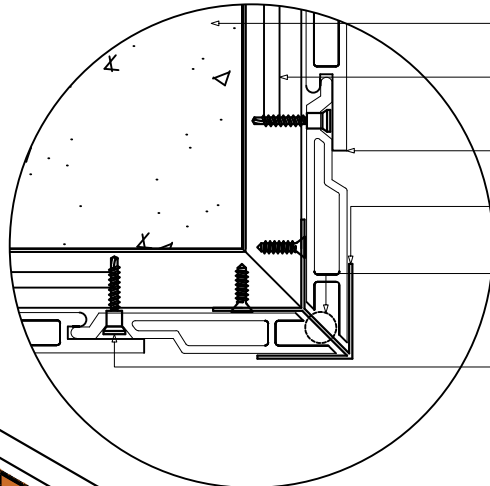
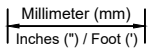

- Existing Wall
- Reverse RESSHTC10P Hat Channel Punched Mill Finish
- RESCPH120612 Siding
- RESSOC10 Outside Corner
- Gap_ Refer to Table 1.4
- RESCPSS25 Stainless Steel Screw

TOP VIEW

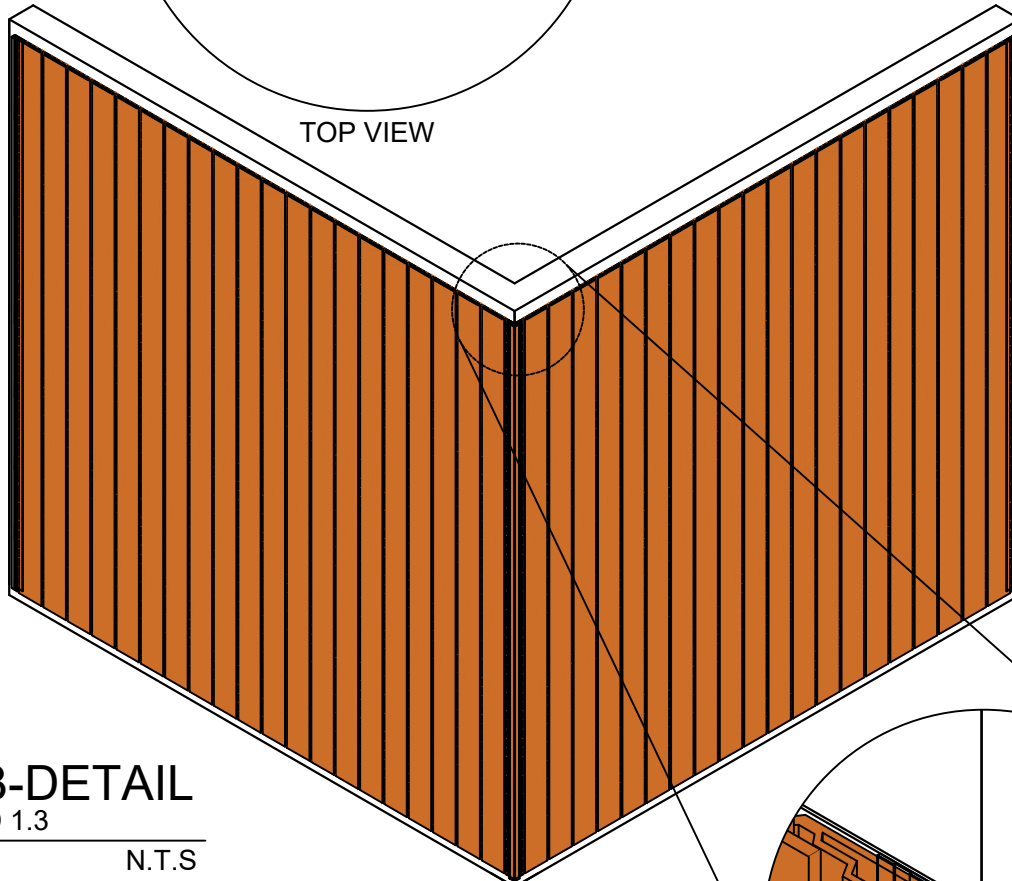

ISOMETRIC VIEW

SUB-DETAIL
ATVSD 1.3

N.T.S

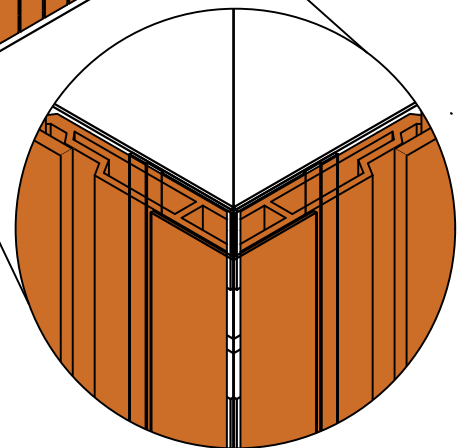

BLOW-UP ISOMETRIC

Table 1.4 "Resysta Expansion"

Resysta Siding Board Gap Guide					
Temperature at Installation	Aluminum Trim Gap of Siding Boards				H-Channel Gap
	Below 30°F	60°F	90°F	120°F	
Amount for Wall cladding Profile - Length of 12 ft.	7/16"	5/16"	3/16"	0"	1/4"

Note :

Outside corner trim should be pre applied prior to installing siding boards. The starter strip for the first board should be installed butted against the corner trim, not overlapping the corner trim attachment. The siding board end that is inserted into the outside corner should be miter cut at a 45 degree angle to match up with the outside corner internal web.



CONTACT PHONE: 503-360-9551 E-MAIL: sales@hdgbuildingmaterials.com WEB: hdgbuildingmaterials.com	TITLE ALUMINUM TRIM VERTICAL SIDING SUB-DETAIL	SHEET CONTENT ISOMETRIC VIEW BLOW-UP ISOMETRIC TOP VIEW	
	SPECIFICATION TYPICAL DRAWING DETAIL	DRAWING NO. ATVSD-04	DATE 03.01.23
		CAD BY:	CHECKED BY:

DIMENSION LEGEND

Millimeter (mm)

Inches (") / Foot (')

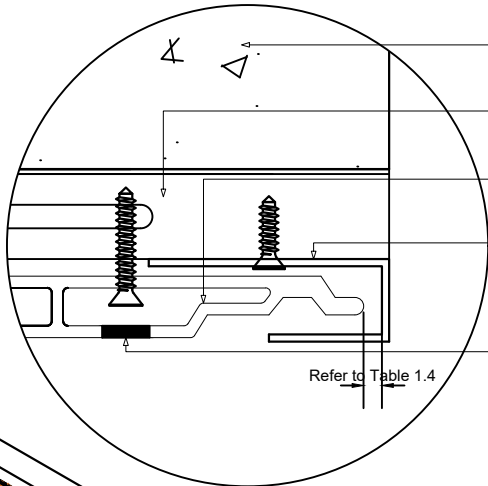

- Existing Wall
- Reverse RESSHTC10P Hat Channel Punched Mill Finish
- RESCPH120612 Siding
- RESSJM10 J Mold
- 10mm / 0.40" ϕ
- Veneer Cap

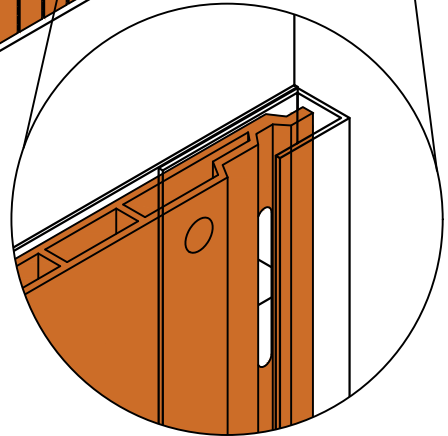
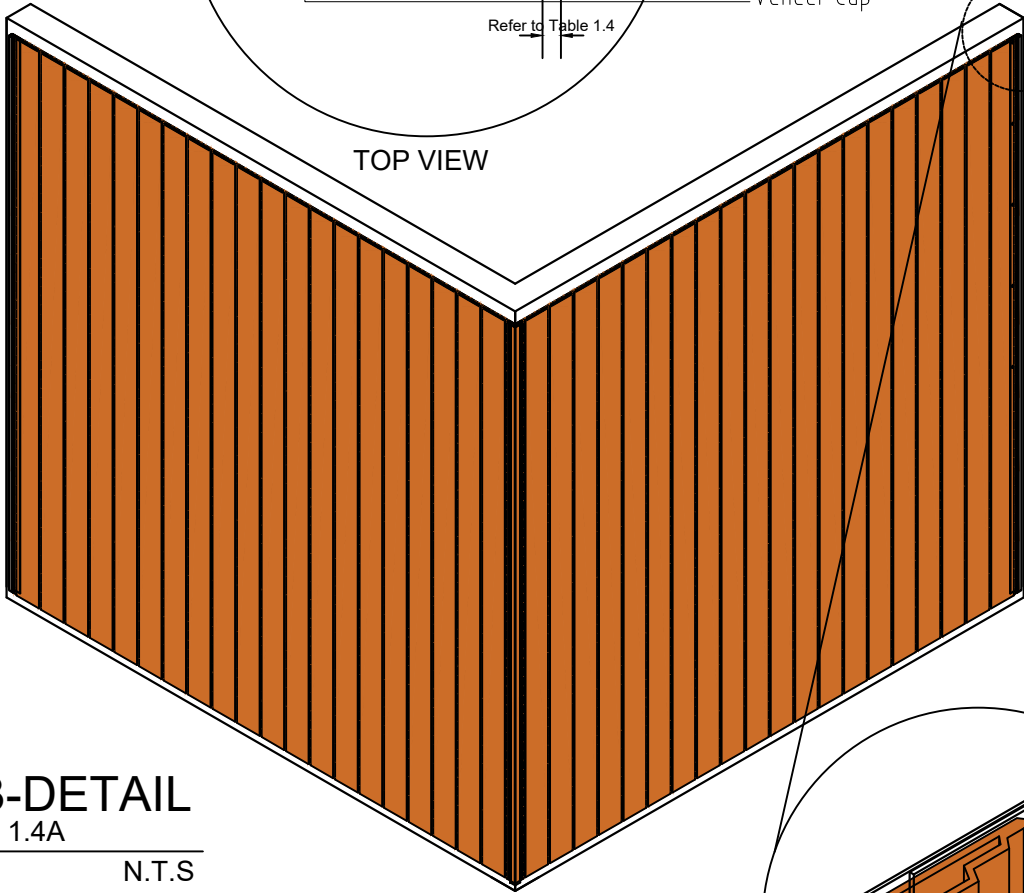

SUB-DETAIL
ATVSD 1.4A

N.T.S

ISOMETRIC VIEW

BLOW-UP ISOMETRIC

Table 1.4 "Resysta Expansion"

Resysta Siding Board Gap Guide					
	Aluminum Trim Gap of Siding Boards				H-Channel Gap
Temperature at Installation	Below 30°F	60°F	90°F	120°F	
Amount for Wall cladding Profile - Length of 12 ft.	7/16"	5/16"	3/16"	0"	1/4"

Note :

When a siding board in either a horizontal or vertical application terminates into a wall, eave, window, door etc. a J-channel should be used to cover the exposed end of the siding board. The J-channel should also be used along the bottom of a vertical installation. J-channel trim should be pre-applied prior to installing siding boards.



CONTACT PHONE: 503-360-9551 E-MAIL: sales@hdgbuildingmaterials.com WEB: hdgbuildingmaterials.com	TITLE ALUMINUM TRIM VERTICAL SIDING SUB-DETAIL	SHEET CONTENT ISOMETRIC VIEW BLOW-UP ISOMETRIC TOP VIEW	
	SPECIFICATION TYPICAL DRAWING DETAIL	DRAWING NO. ATVSD-05	DATE 03.01.23
		CAD BY:	CHECKED BY:

DIMENSION LEGEND

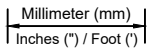

J Mold 3mm Ø Weep hole every 6"

RESSJM10 J Mold

RESCPH120612 Siding

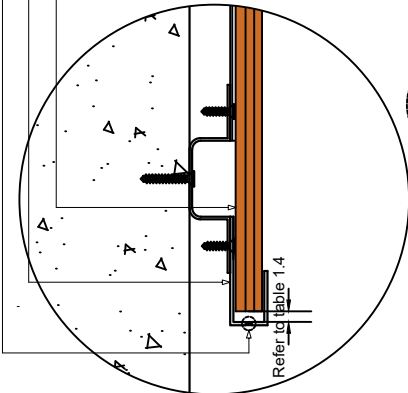

SECTION

Reverse RESSHTC10P Hat Channel Punched Mill Finish
RESSJS10 Siding Starter J Strip

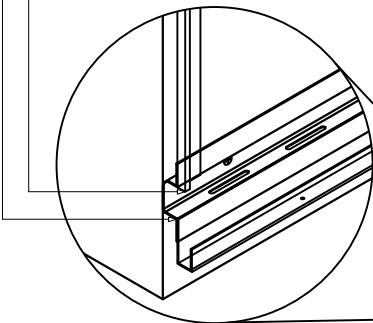

BLOW-UP ISOMETRIC

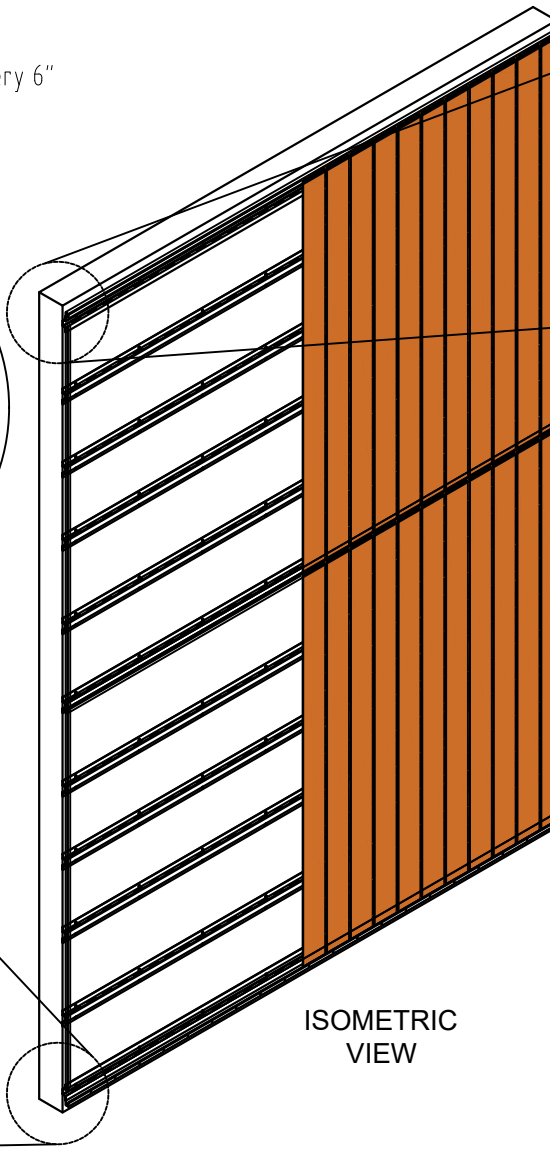

ISOMETRIC VIEW

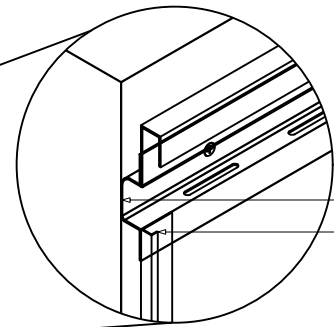

BLOW-UP ISOMETRIC

RESSJS10 Siding Starter J Strip

Reverse RESSHTC10P Hat Channel Punched Mill Finish

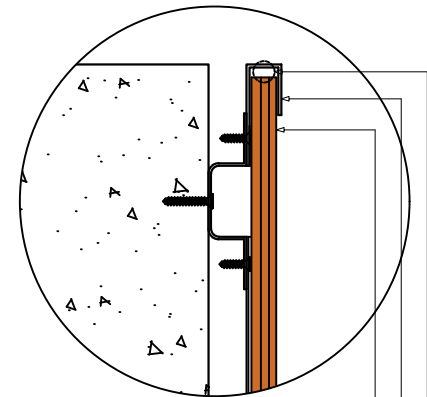

SECTION

RESCPH120612 Siding

RESSJM10 J Mold

Gap_Refer to Table 1.4

Table 1.4 "Resysta Expansion"

Resysta Siding Board Gap Guide					
Temperature at Installation	Aluminum Trim Gap of Siding Boards				H-Channel Gap
	Below 30°F	60°F	90°F	120°F	
Amount for Wall cladding Profile - Length of 12 ft.	7/16"	5/16"	3/16"	0"	1/4"

SUB-DETAIL
ATVSD 1.4B

N.T.S

Note :

When a siding board in either a horizontal or vertical application terminates into a wall, eave, window, door etc. a J-channel should be used to cover the exposed end of the siding board. The J-channel should also be used along the bottom of a vertical installation. J-channel trim should be pre-applied prior to installing siding boards.



CONTACT PHONE: 503-360-9551 E-MAIL: sales@hdgbuildingmaterials.com WEB: hdgbuildingmaterials.com	TITLE	SHEET CONTENT	
	ALUMINUM TRIM VERTICAL SIDING SUB-DETAIL	ISOMETRIC VIEW	
SPECIFICATION TYPICAL DRAWING DETAIL		BLOW-UP ISOMETRIC	
		SECTION	
	DRAWING NO.	ATVSD-06	DATE
			03.01.23
	CAD BY:		CHECKED BY:

DIMENSION LEGEND

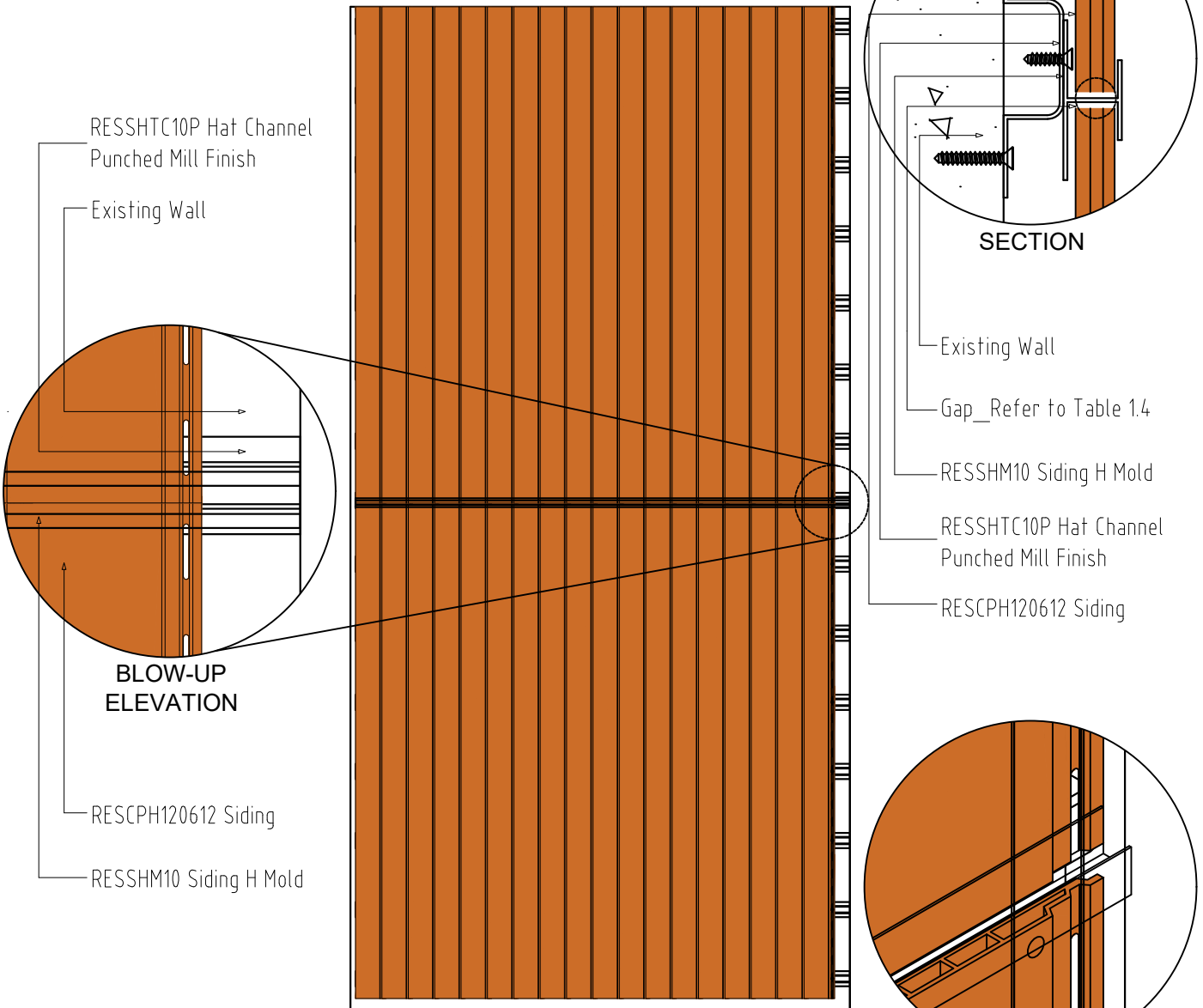
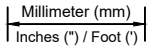

FRONT ELEVATION

Table 1.4 "Resysta Expansion"

Resysta Siding Board Gap Guide					
Temperature at Installation	Aluminum Trim Gap of Siding Boards				H-Channel Gap
	Below 30°F	60°F	90°F	120°F	
Amount for Wall cladding Profile - Length of 12 ft.	7/16"	5/16"	3/16"	0"	1/4"

SUB-DETAIL
ATVSD 1.5

N.T.S

Note :

An H-Channel should be installed at each board abutment joint to cover the ends of the Resysta siding board. This is a option for installations using 3 or more boards abutted end-to-end



CONTACT PHONE: 503-360-9551 E-MAIL: sales@hdgbuildingmaterials.com WEB: hdgbuildingmaterials.com	TITLE ALUMINUM TRIM VERTICAL SIDING SUB-DETAIL	SHEET CONTENT		
	SPECIFICATION TYPICAL DRAWING DETAIL	ELEVATION BLOW-UP DETAIL SECTION ISOMETRIC VIEW		
		DRAWING NO.	DATE	
		ATVSD-07	03.01.23	
	CAD BY:	CHECKED BY:		